



DRAWN BY:  
JL, SB

WEST VILLAGE  
OTIS STREET  
ASHLAND, OR, 97520

JOB NO. 1921  
REVISION DATE

LANDSCAPE  
PLANTING  
PLAN

ISSUE DATE:  
08.01.2019

L 4.0

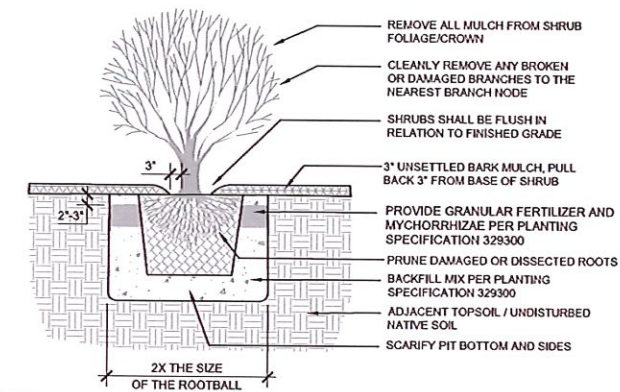
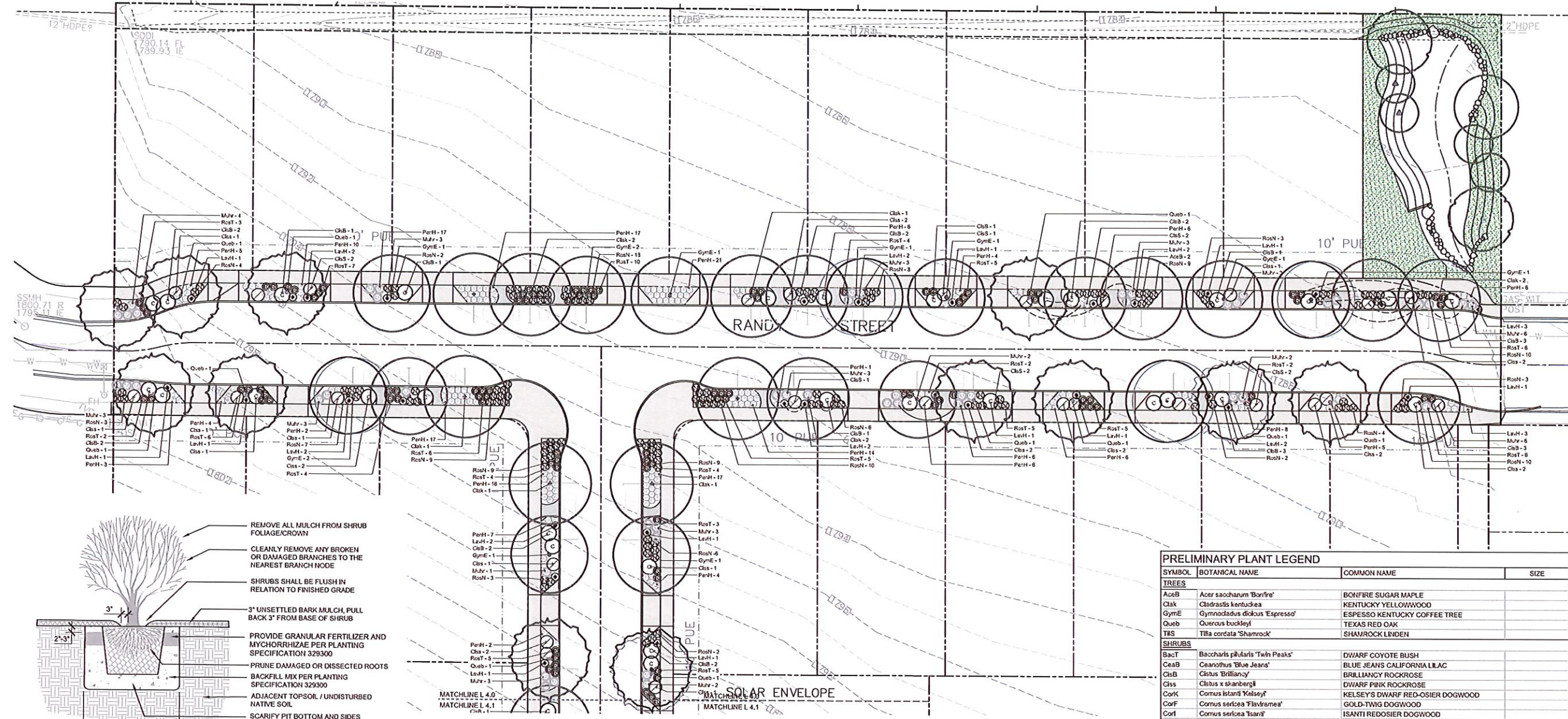

- NOTE:  
1. PRUNE ALL DAMAGED, DISEASED, OR WEAK LIMBS AND ROOTS.  
2. CLEANLY PRUNE ALL DAMAGED ROOT ENDS.  
3. ADD GRANULAR FERTILIZER AND MYCORRHIZAE PER PLANTING SPECIFICATION 329300.

**1 SECTION: SHRUB PLANTING**  
Scale: N.T.S.

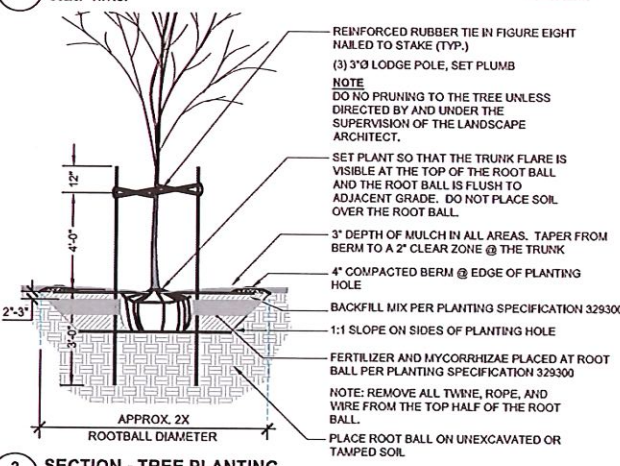

**2 SECTION - TREE PLANTING**  
Scale: 1/2" = 1'-0"

**PLANT SPACING MULTIPLICATION TABLE**

SPACING	X FACTOR
12" O.C.	1.156 (X AREA)
18" O.C.	0.513
24" O.C.	0.288
30" O.C.	0.184
36" O.C.	0.128
48" O.C.	0.072

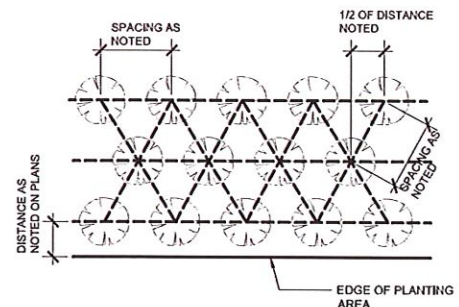

**3 SECTION: GROUNDCOVER PLANTING LAYOUT**  
Scale: N.T.S.

**PRELIMINARY PLANT LEGEND**

SYMBOL	BOTANICAL NAME	COMMON NAME	SIZE
<b>TREES</b>			
AceB	Acer saccharum 'Bonfire'	BONFIRE SUGAR MAPLE	
Clak	Cladrasis kentuckea	KENTUCKY YELLOWWOOD	
GymE	Gymnodadus dickus 'Espresso'	ESPRESSO KENTUCKY COFFEE TREE	
QueB	Quercus buckleyi	TEXAS RED OAK	
TBS	Tilia cordata 'Shamrock'	SHAMROCK LINDEN	
<b>SHRUBS</b>			
BacT	Baccharis pilularis 'Twin Peaks'	DWARF COYOTE BUSH	
CeaB	Ceanothus 'Blue Jeans'	BLUE JEANS CALIFORNIA LILAC	
CisB	Cistus 'Brillancy'	BRILLANCY ROCKROSE	
Ciss	Cistus x shanbergii	DWARF PINK ROCKROSE	
CorK	Cornus island 'Kelsey'	KELSEY'S DWARF RED-OSIER DOGWOOD	
CorF	Cornus sericea 'Flavivirens'	GOLD-TWIG DOGWOOD	
CorI	Cornus sericea 'Tsani'	ISANTI REDOSIER DOGWOOD	
Fels	Feljoa sellowiana	PINEAPPLE GUAVA	
GarF	Garrya fremontii	FREMONT'S SILKTASSEL	
GenV	Geriola pilosa 'Vancouver Gold'	VANCOUVER GOLD LYDIA WOODWAXEN	
LavH	Lavandula a. 'Hidcote Blue'	HIDCOTE BLUE ENGLISH LAVENDER	
LabC	Malvella aquifolium 'Compacta'	COMPACT OREGON GRAPE HOLLY	
MaH	Muhlenbergia rigens	DEER GRASS	
ParH	Penstemon 'Hornbl'	HAMELN FOUNTAIN GRASS	
RhaE	Rhamnus californica 'Eye Case'	EYE CASE COFFEEBERRY	
RhuG	Rhus aromatica 'Gro-Low'	GRO-LOW FRAGRANT SUMAC	
Riba	Ribes aurum	FLOWERING CURRANT	
RosH	Rosa x 'Noare'	RED CARPET FLOWER	
RosT	Rosa x 'Noatraum'	PINK CARPET FLOWER	
RosH	Rosa rugosa 'Hansa'	HANSA RUGOSA ROSE	
Teuc	Teucrium chamaedrys	WALL GERMANDER	
Via	Vitex agnus-castus	CHASTE TREE	
WiaA	Wisteria 'Amethyst Falls'	AMETHYST FALLS AMERICAN WISTERIA	
<b>GROUNDCOVER</b>			
	Achillea 'Moonshine'	MOONSHINE YARROW	4" POT @ 18" OC

NOTE: MATURE COMPOST SHALL BE ADDED TO THE TOPSOIL OF LANDSCAPING AREAS AT A RATE OF THREE CUBIC YARDS OF COMPOST PER 1,000 SQUARE FEET OF LANDSCAPING AREA TO BE PLANTED.

**PRELIMINARY PLANT LEGEND**

- All landscape planting areas shall receive clean, sandy loam topsoil to a minimum depth of 12" or as noted on the plan. Additionally, all planting areas will be prepared per the procedures as outlined in the Medford Development Code, Section 10.780(G)(9)(b).
- All proposed street and site trees will have a minimum of (2) cubic feet of soil volume for each square foot of tree canopy at maturity. Soil volume will be achieved by means of topsoil in planters and structural soil under impervious surfaces.
- All planting areas shall receive 3" of unsettled organic mulch.
- The proposed lawn area shall consist of a low water use and shade tolerant red fescue seed mix.
- All planting areas shall be served by a designated 3/4" domestic water meter and a City of Medford approved backflow prevention device.
- The irrigation system will provide a fully automatic irrigation controller that will meet the requirements as noted in the Medford Development Code, Section 10.780(H)(4).
- The proposed irrigation system will consist of low volume distribution.

City of Ashland Planning Exhibit  
SCALE: 1/2" = 20'-0"

Exhibit # P-001  
PA # PA-T2-2019-0013  
Date 9-10-2019  
Staff JL