

Council Business Meeting

August 6, 2019

Agenda Item	Approval of Liquor License Request for Mary's BBQ Place LLC	
From	Melissa Huhtala	City Recorder
Contact	Melissa.huhtala@ashland.or.us ; (541) 488-2307	

SUMMARY

This is a request for approval of a Liquor License Application from Mary's BBQ Place LLC located at 3070 Highway 66, Ashland, OR 97520.

POLICIES, PLANS & GOALS SUPPORTED

AMC Chapter 6.32 Liquor License Review

PREVIOUS COUNCIL ACTION

N/A

BACKGROUND AND ADDITIONAL INFORMATION

This is an application for Limited On-Premises Liquor License.

FISCAL IMPACTS

N/A

STAFF RECOMMENDATION

Staff recommends approval of the Liquor License application. The City has determined that the location of this business complies with the City's land use requirements and that the applicant has a Business License and has registered as a restaurant.

ACTIONS, OPTIONS & POTENTIAL MOTIONS

I move to approve the Liquor License for Mary's BBQ Place LLC.

REFERENCES & ATTACHMENTS

Attachment 1: Application



OREGON LIQUOR CONTROL COMMISSION

LIQUOR LICENSE APPLICATION

1. Application. **Do not include** any OLCC fees with your application packet (the license fee will be collected at a later time). Application is being made for:

License Applied For:	CITY AND COUNTY USE ONLY
<input type="checkbox"/> Brewery 1 st Location	Date application received: _____
<input type="checkbox"/> Brewery 2 nd Location	Name of City or County: _____
<input type="checkbox"/> Brewery 3 rd Location	Recommends this license be: <input type="checkbox"/> Granted <input type="checkbox"/> Denied
<input type="checkbox"/> Brewery-Public House 1 st location	By: _____
<input type="checkbox"/> Brewery-Public House 2 nd location	Date: _____
<input type="checkbox"/> Brewery-Public House 3 rd location	
<input type="checkbox"/> Distillery	
<input type="checkbox"/> Full On-Premises, Commercial	
<input type="checkbox"/> Full On-Premises, Caterer	
<input type="checkbox"/> Full On-Premises, Passenger Carrier	
<input type="checkbox"/> Full On-Premises, Other Public Location	
<input type="checkbox"/> Full On-Premises, For Profit Private Club	
<input type="checkbox"/> Full On-Premises, Nonprofit Private Club	
<input type="checkbox"/> Grower Sales Privilege 1 st location	
<input type="checkbox"/> Grower Sales Privilege 2 nd location	
<input type="checkbox"/> Grower Sales Privilege 3 rd location	
<input checked="" type="checkbox"/> Limited On-Premises	OLCC USE ONLY
<input type="checkbox"/> Off-Premises	Date application received: _____
<input type="checkbox"/> Off-Premises with Fuel Pumps	By: _____
<input type="checkbox"/> Warehouse	Date application accepted as initially complete: _____
<input type="checkbox"/> Wholesale Malt Beverage & Wine	By: _____
<input type="checkbox"/> Winery 1 st Location	License Action(s): _____
<input type="checkbox"/> Winery 2 nd Location	
<input type="checkbox"/> Winery 3 rd Location	

2. Identify the applicant(s) applying for the license(s). ENTITY (example: corporation or LLC) or INDIVIDUAL(S) applying for the license(s):

City of Ashland

Mary's BBQ Place LLC

(Applicant #1)

(Applicant #2)

(Applicant #3)

(Applicant #4)

OLCC USE ONLY	OLCC FINANCIAL SERVICES USE ONLY

OREGON LIQUOR CONTROL COMMISSION
LIMITED LIABILITY COMPANY QUESTIONNAIRE



Please Print or Type

LLC Name: Mary's BBQ Place Year Filed: 2016

Trade Name (dba): Mary's BBQ Place

Business Location Address: 3070 OR- 66

City: Ashland ZIP Code: 97520

List Members of LLC:

Percentage of Membership Interest:

1. <u>Mary O'Brien</u> (managing member)	<u>100%</u>
2. _____ (members)	_____
3. _____	_____
4. _____	_____
5. _____	_____
6. _____	_____

(Note: If any LLC member is another legal entity, that entity must also complete an LLC, Limited Partnership or Corporation Questionnaire. If the LLC has officers, please list them on a separate sheet of paper with their titles.)

Server Education Designee: Mary O'Brien DOB: 11/06/1974

I understand that if my answers are not true and complete, the OLCC may deny my license application.

Signature: Mary O'Brien Owner Date: 7/9/2019
(name) (title)



OREGON LIQUOR CONTROL COMMISSION BUSINESS INFORMATION

Please Print or Type

Applicant Name: City of Ashland Phone: (541) 482-4311

Trade Name (dba): Oak Knoll Golf Course

Business Location Address: 3070 Highway 66

City: Ashland ZIP Code: 97520

DAYS AND HOURS OF OPERATION

Business Hours:

Sunday	<u>7 am</u>	to	<u>7 pm</u>
Monday	<u>7 am</u>	to	<u>7 pm</u>
Tuesday	<u>7 am</u>	to	<u>7 pm</u>
Wednesday	<u>7 am</u>	to	<u>7 pm</u>
Thursday	<u>7 am</u>	to	<u>7 pm</u>
Friday	<u>7 am</u>	to	<u>7 pm</u>
Saturday	<u>7 am</u>	to	<u>7 pm</u>

Outdoor Area Hours:

Sunday	<u>7 am</u>	to	<u>7 pm</u>
Monday	<u>7 am</u>	to	<u>7 pm</u>
Tuesday	<u>7 am</u>	to	<u>7 pm</u>
Wednesday	<u>7 am</u>	to	<u>7 pm</u>
Thursday	<u>7 am</u>	to	<u>7 pm</u>
Friday	<u>7 am</u>	to	<u>7 pm</u>
Saturday	<u>7 am</u>	to	<u>7 pm</u>

The outdoor area is used for:

- ☒ Food service Hours: 8 am to 7 pm
☒ Alcohol service Hours: 8 am to 7 pm
☒ Enclosed, how Covered by roof, encompassed by railing.

The exterior area is adequately viewed and/or supervised by Service Permittees.

(Investigator's Initials)

Seasonal Variations: ☒ Yes ☐ No If yes, explain: Shorter hours in the off season. 8-5pm

ENTERTAINMENT

Check all that apply:

- | | |
|---|---|
| <input checked="" type="checkbox"/> Live Music | <input type="checkbox"/> Karaoke |
| <input checked="" type="checkbox"/> Recorded Music | <input type="checkbox"/> Coin-operated Games |
| <input checked="" type="checkbox"/> DJ Music | <input type="checkbox"/> Video Lottery Machines |
| <input checked="" type="checkbox"/> Dancing | <input type="checkbox"/> Social Gaming |
| <input type="checkbox"/> Nude Entertainers | <input type="checkbox"/> Pool Tables |
| <input checked="" type="checkbox"/> Other: <u>Golf Course & Driving Range</u> | |

DAYS & HOURS OF LIVE OR DJ MUSIC

Sunday	_____	to	_____
Monday	_____	to	_____
Tuesday	_____	to	_____
Wednesday	_____	to	_____
Thursday	_____	to	_____
Friday	_____	to	_____
Saturday	_____	to	_____

*Live music is 2-3 times a year.

SEATING COUNT

Restaurant: 20 Outdoor: 16
Lounge: _____ Other (explain): _____
Banquet: _____ Total Seating: 36

OLCC USE ONLY

Investigator Verified Seating: (Y) (N)
Investigator Initials: _____
Date: _____

I understand if my answers are not true and complete, the OLCC may deny my license application.

Applicant Signature: _____ Date: 7/8/2019

1-800-452-OLCC (6522)
www.oregon.gov/olcc

(rev. 12/07)

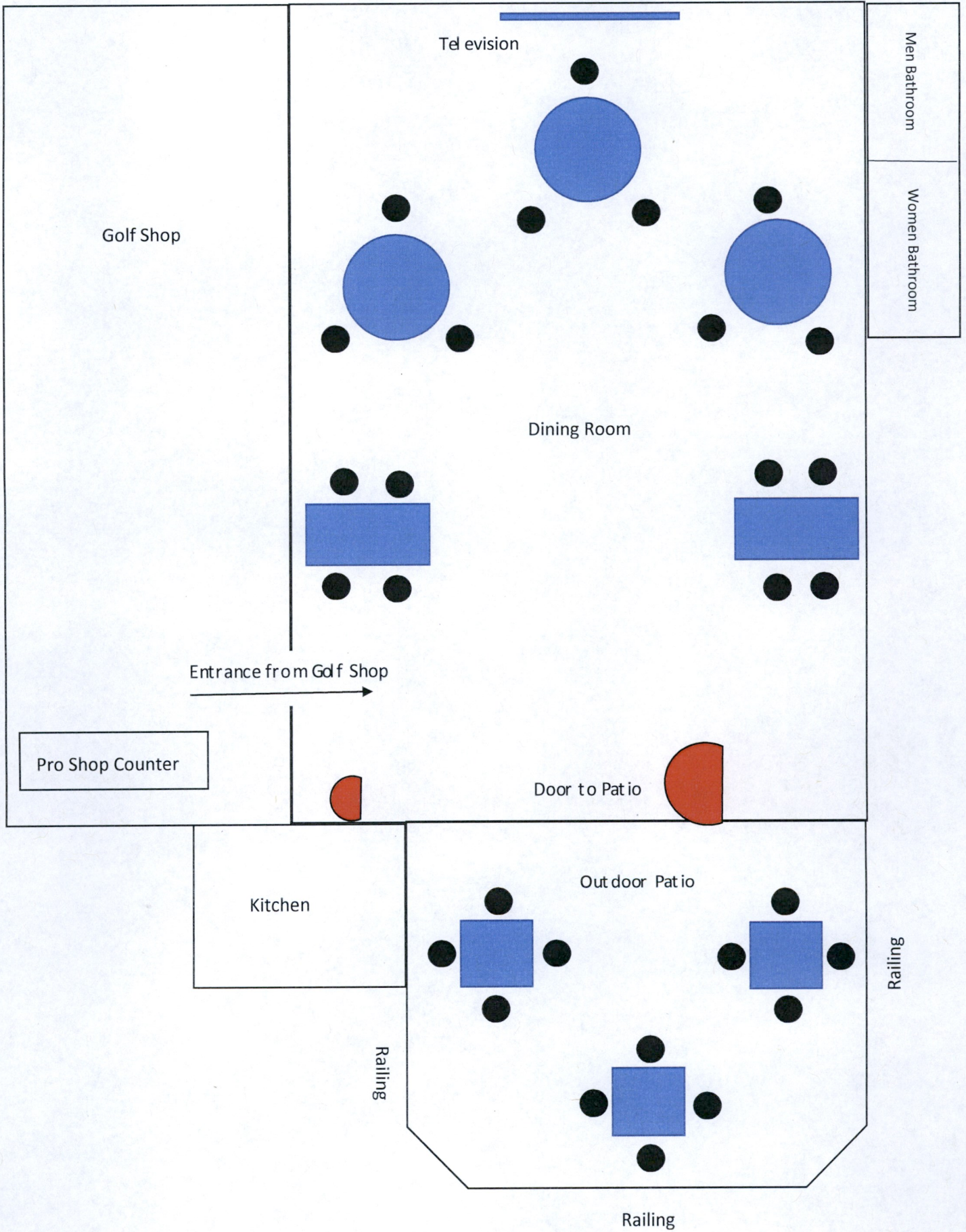

SIDE CHOICES

RED POTATO SALAD, MACARONI SALAD,
BAKED BEANS, COLESLAW, GREEN SALAD, OR
BAKED POTATO

SANDWICHES \$7

YOUR CHOICE OF MEAT

3 RIBS ONLY \$6

STUFFED BAKED POTATO \$9

BAKED POTATO STUFFED WITH MEAT, BUTTER,
SOUR CREAM, CHEESE & BBQ SAUCE.

SMOKER LUNCH PLATE \$10

SANDWICH OR RIBS, SIDE, & SODA

SIDES 8 OZ. \$3
 32 OZ. \$12

GARLIC BREAD SLICE \$1
 LOAF \$5

SODA 20 OZ \$1.50
 32 OZ \$2.50

BEER AND CIDER AVAILABLE IN HOUSE ONLY



841 E. PINE ST CENTRAL POINT

MEAT CHOICES

TRI TIP, BONELESS SKINLESS CHICKEN THIGHS,
PULLED PORK, TAYLOR SPICY ITALIAN SAUSAGE, OR
PORK SPARE RIBS

MEAT SM/MED/LARGE

TRI TIP \$7/\$14/\$27

PULLED PORK \$6/\$11/\$22

CHICKEN \$5/\$7/\$12

RIBS \$6 FOR 3 OR \$20 RACK

DINNERS FOR FOUR

ALL DINNERS INCLUDE MEAT, TWO 32 OZ SIDES & A
WHOLE LOAF GARLIC FRENCH BREAD

TRI TIP DINNER \$52

PULLED PORK DINNER \$45

PORK RIB DINNER \$40

CHICKEN DINNER \$35

OPEN 11AM -8 PM
www.marysbbqplace.com
on FACEBOOK!

541-727-7079 CALL AHEAD